



Installation Instructions

This manual must be read thoroughly
BEFORE Commencing installation

Version 4 - September 2018

Contents

03	Do's & don'ts
03	Recommended tools
03	Conditioning & storage
04	Supporting profiles
04	Recommended panel adhesive & sealant
05	Measuring, marking & cutting panels
06	Installing onto new or existing framework
	Finishing at the base of the panel
07	Option 1: Finishing with safety or vinyl flooring
08	Option 2: Finishing onto tiled skirting (tile on edge)
09	Option 3a: Finishing onto shower base, bath tub or pre-existing tiled floor
10	Option 3b: Finishing onto a shower base or bath tub using the Sureseal
11	Option 3c: Finishing onto pre-tiled floors and silicone sealing
12	Fitting the Sureseal
13	Option 4: Finishing Spanpanel behind tiled flooring
14	Option 5: Finishing behind tiled skirting (tile on edge)
15	Hydrolock tongue & groove panels
16	Hidden internal corner installation
17	Fixing onto framework using standard internal corner & Hydrolock panels
18	Full room installation and final panel install
19	Installation around window reveals
20	Cutting for pipes

Do's & Dont's

Installer Responsibility

Prior to commencing installation please carefully read this installation booklet in full paying particular attention to the do's and don'ts.

IMPORTANT: It is important that you follow and adhere to all of the instructions to ensure the most effective use of the product. To maintain the validity of your guarantee you **MUST** follow the installation instructions provided. Failure to do this will make all aspects of the guarantee invalid.

If there is any aspect of your particular installation that these instructions do not cover please clarify any queries before commencing your installation. Your installation may require specific procedures and adjustments.

✓ PLEASE DO

- ✓ **DO** always store Spanpanel flat to prevent bowing
- ✓ **DO** acclimatise the panels and accessories for 72 hours prior to installation in normal heated/dry conditions
- ✓ **DO** use only our recommended sealant and adhesives
- ✓ **DO** ensure that sealant is applied correctly at all stated points
- ✓ **DO** closely inspect each panel for manufacturing/material surface defects prior to and during installation
- ✓ **DO** always follow BCA requirements where required

X PLEASE DON'T

- X **DON'T** store the panels outside or in wet or humid conditions
- X **DON'T** store panels propped against a wall on edge or end
- X **DON'T** install panels on uneven or out of plumb walls
- X **DON'T** use abrasive cleaners and bleaches to clean the panels
- X **DON'T** fit Spanpanels without correctly sealing every joint
- X **DON'T** drag or slide panels when stacked on top of each other. Use two people to lift

Recommended tools for installation

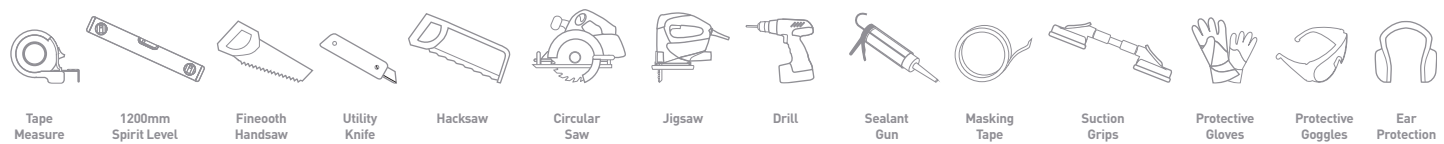

Ensure all tools are used safely and correctly and appropriate safety wear such as gloves, eye and ear protection are used

Conditioning and storage

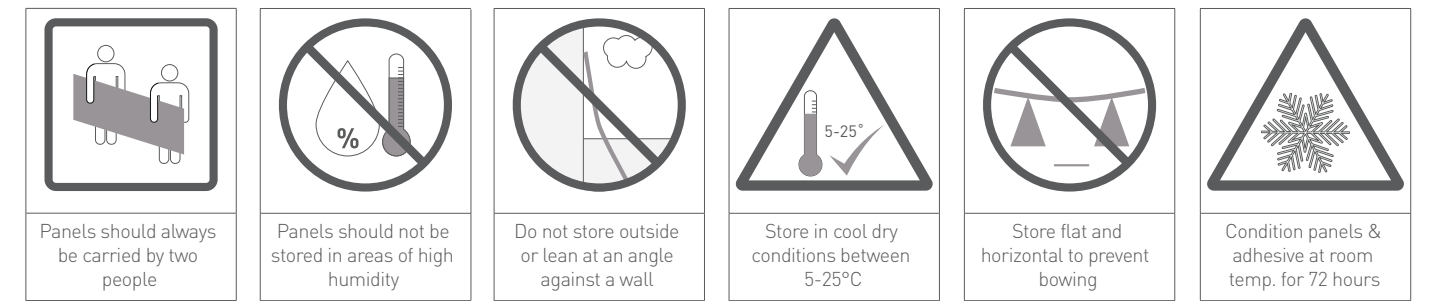

Spanpanel can be installed by any competent DIY person or licensed trades person. If designed, used and installed in accordance with the Spanpanel installation instructions and the Spanpanel BRANZ appraisal (No. 906,2016)

Supporting profiles and accessories

Ensure you have all of the required components for your installation.

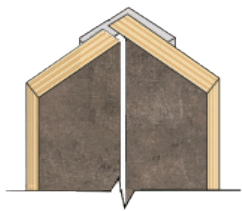

Hidden Internal Corner

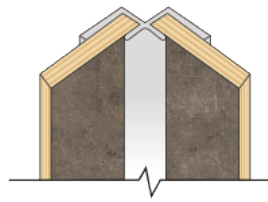

Standard Internal Corner

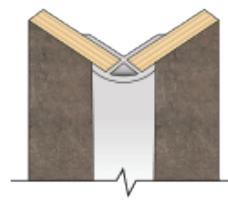

External Corner 1

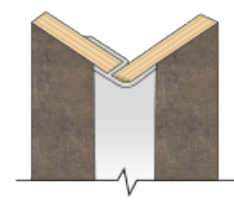

External Corner 2

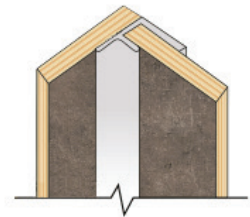

Last Corner Profile

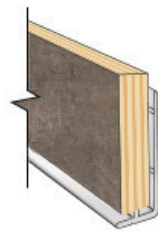

Type X - Base Profile



End Cap

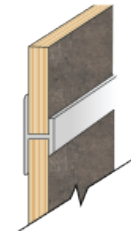

Stacking H-Joint

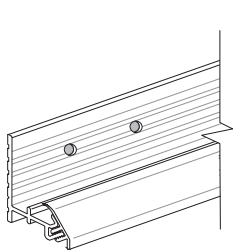

Sureseal Base Profile

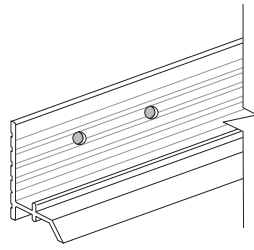

Spapanel Base Seal Profile



Adhesive and Sealant

Always use the correct panel adhesive, sealants and cleaners.

It is strongly advised that you use only Adhesives and Sealants that have been approved or recommended by Spapanel when installing Spapanel.

NOTE: Using poor quality Adhesives or Sealants or one that has not been recommended, may invalidate your warranty!

It is the owners responsibility to periodically check the performance of any sealant and must notify the installer ASAP if they feel that it needs attention or replacement. Failure to maintain the sealant may invalidate the product warranty and guarantee!

Recommended Panel Adhesive, Sealants and Cleaners:

Panel Adhesive; Soudal Fix All High-Tack or Soudaseal 240FC adhesive for fixing of the Spapanel to either a backing board or directly onto timber or metal frame work.

Silicone Sealant; Soudal Silirub 2/S for sealing of all profile trims and at the base of the panel.

Cleaners; Once installed Spapanel requires minimal maintenance. Spapanel can be cleaned with warm water and a non-abrasive mild detergent or cleaners that are non-abrasive, chemically pH neutral and sterilising. Scouring products or similar products should not be used; doing so may invalidate your warranty.

NOTE: Exposed bottom edge sealants may need to be replaced periodically, and or as necessary dependent upon shower usage.

Measuring - marking out and cutting panels

Check all panels before cutting and during installation for any visible defects. Once the panels have been cut they have been deemed acceptable for installation.

Spanpanel has sharp corners and edges - therefore gloves should be worn at all times when carrying, handling and fitting panels. Appropriate personal protection equipment such as safety eyewear should be worn when cutting the panels.

NOTE: Always consider and allow for the trim dimensions when cutting the panels to size

Measure and mark your required cutting line. If your panels are to be installed full height to ceiling level, cut the height of the panel to allow a 3mm expansion gap at the ceiling point which will be filled with sealant on completion of the installation.

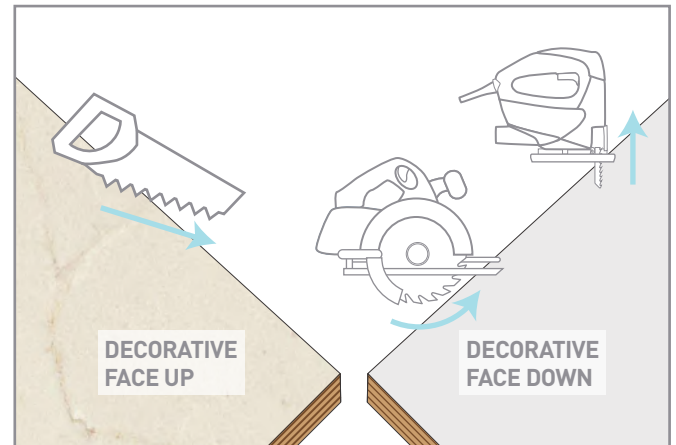

Note: Ensure your tool blade always cuts into the decorative face to avoid chipping the laminate

When using a jigsaw or circular saw with an upward cutting blade, the panels should be cut from the back, decorative face down to prevent chipping of the laminate surface.

Installing onto new or existing wall linings

Includes tiled, Fibre Cement Plasterboard, Plywood, OSB, Brick or Concrete Walls.

Follow the instructions below if you plan to install Spanpanel directly over new or existing flat surface substrate walls.

For all surfaces with no previously applied waterproof membrane, a membrane should be applied to a minimum of 50-150mm up from the floor in accordance with current BCA guidelines.

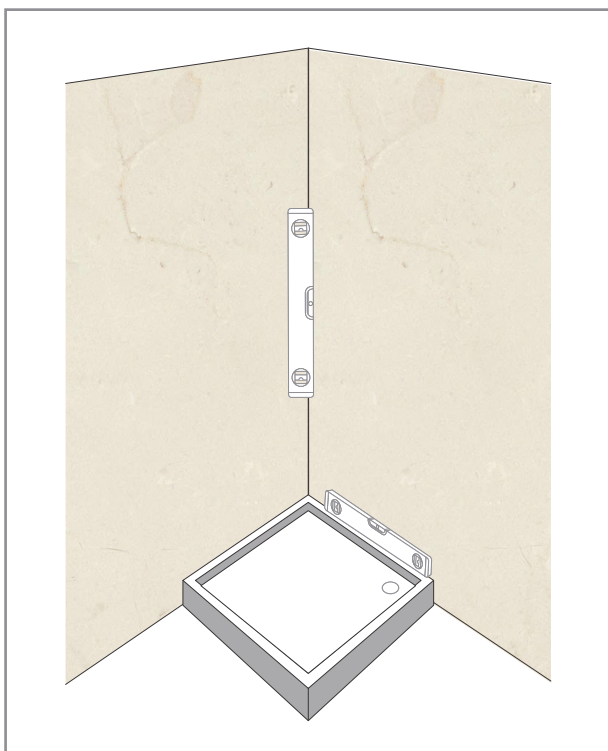

If installing panels directly to new or existing wall linings it is essential that they are sound, plumb, completely dry and clean and dust free.

If fixing direct to a tiled surface the tiles must be sound and degreased first.

If walls are uneven or out of plumb, 18mm x 40mm H3.1 battens must be installed to make a level surface. Set at 450-600mm vertically and 600mm horizontally.

Check the walls carefully for high spots and remove any tiles or fittings which may interfere with the panels as this could create a wavy result when the panel is installed.

Loose or unsound tiles should be removed before fitting panelling. Ensure the shower base or floor is also located level using a spirit level.

Note: Any unsound or out of plumb tiled or plastered walls should have appropriate remedial work conducted to ensure the substrate meets the set standard for the installation as stated previously.

Installing directly onto new or existing framework

New or existing frame preparation -

Place vertical uprights at 450mm **or** 600mm centres and cross noggins at 600mm centres.

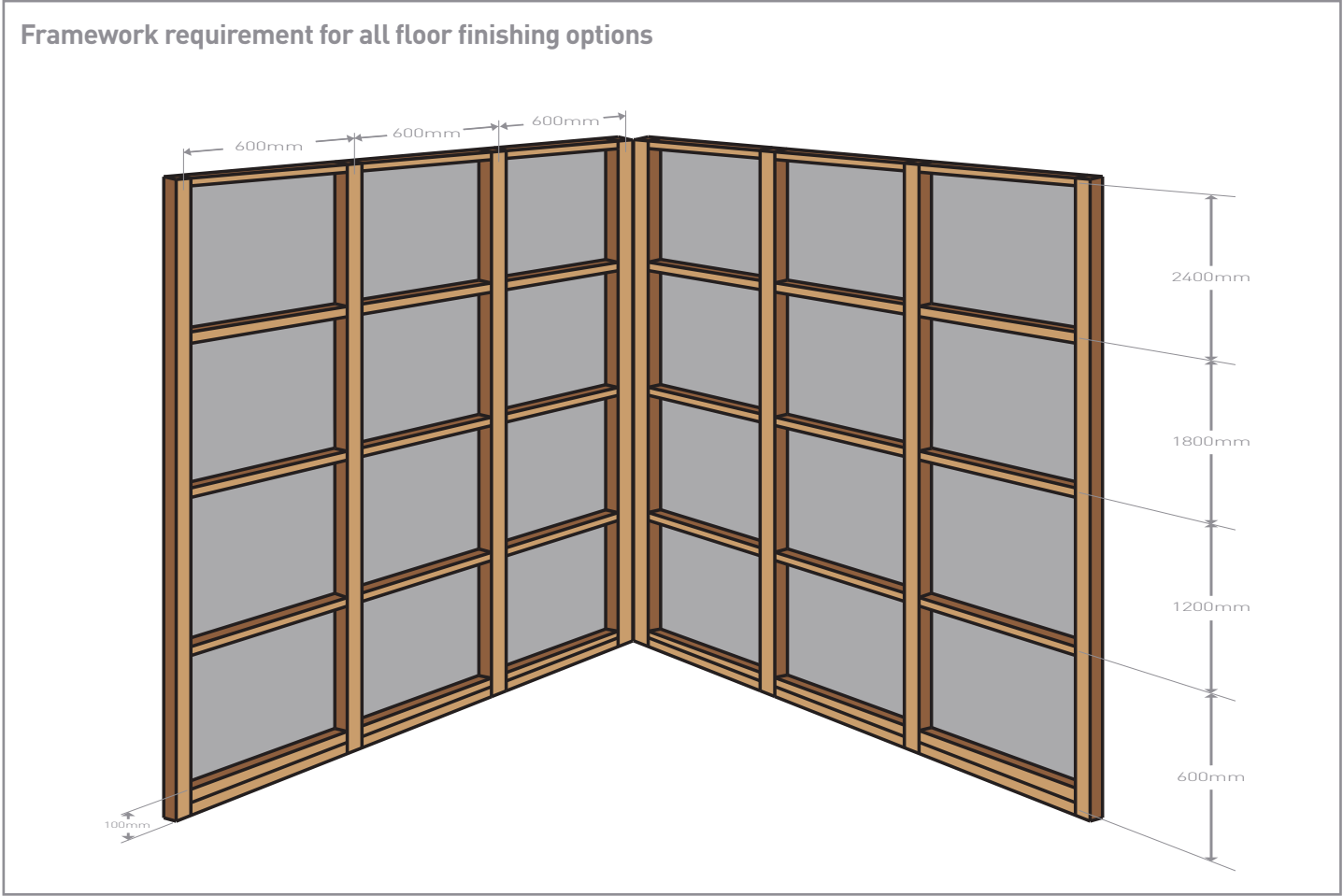

Fixing to framework studs

Care must be taken when building new framework to ensure that it is built straight and level. When removing existing wall linings ensure that the existing framework is adjusted to 450mm or 600mm vertical centres, 600mm cross noggins.

100mm x 50mm (4 x 2) timber should be used for the vertical uprights, cross noggins and top and bottom plates.

For all floor finishing options a secondary 100mm x 50mm (4 x 2) base plate should be installed. See instructions on pages 7 to 14.

NOTE: Fitting panels directly to uneven framework will affect the quality of the panel joints.

Ensure all vertical panel joints are supported appropriately by vertical timber, the spacing of which should be determined to suit your particular panel face width being installed.

NOTE: All framework must be installed plumb and parallel. If framework is uneven, packing spacers should be used to ensure that all surface faces are level.

Additional framework should be positioned to carry heavy items such as hand basins, wall mounted toilets or furniture. Vertical battens should also be present in the corners to support the corner profiles.

NOTE: If your bottom support is not level it will affect the vertical panel joints and top panel edge of the installed panels.

Finishing at the base of the panel

Option 1: Finishing with Safety or Vinyl Flooring

What to use - Use the Type X Profile, (See diagram Option 1 below)

- (1) Apply a generous bead of sealant to the back upright of the Type X profile.
- (2) Place the Type X profile approximately 100mm (4") from the floor. Using SS CS 4mm x 35mm Screws fix the Type X profile into the wall or timber framework or timber battens.
- (3) Apply a continuous line of sealant onto the Type X back upstand and the panel support nib. Ensure the sealant exceeds the height of the support nib.
- (4) After installing a Spapanel board smooth off and remove any excess sealant at the bottom of the panel where your Spapanel board meets the Type X profile.
- (5) Apply any extra sealant if required. The floor covering material should continue approximately 50mm up the wall and behind the panel.

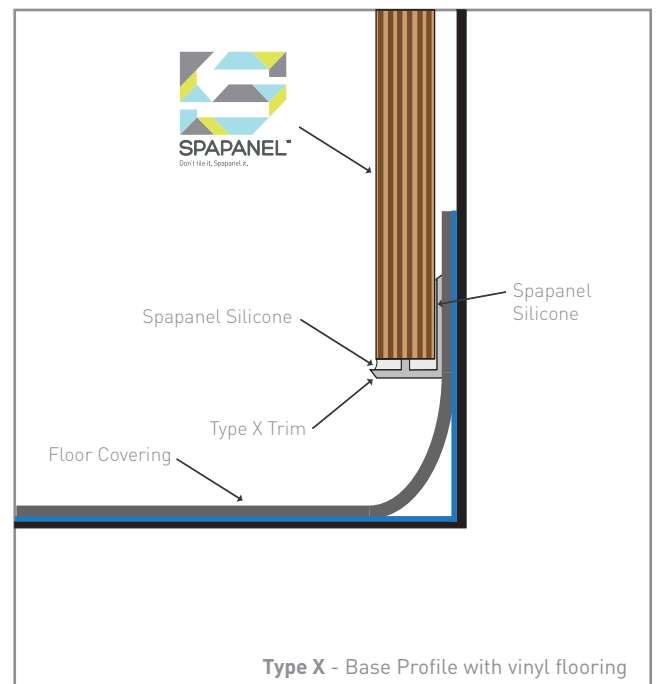
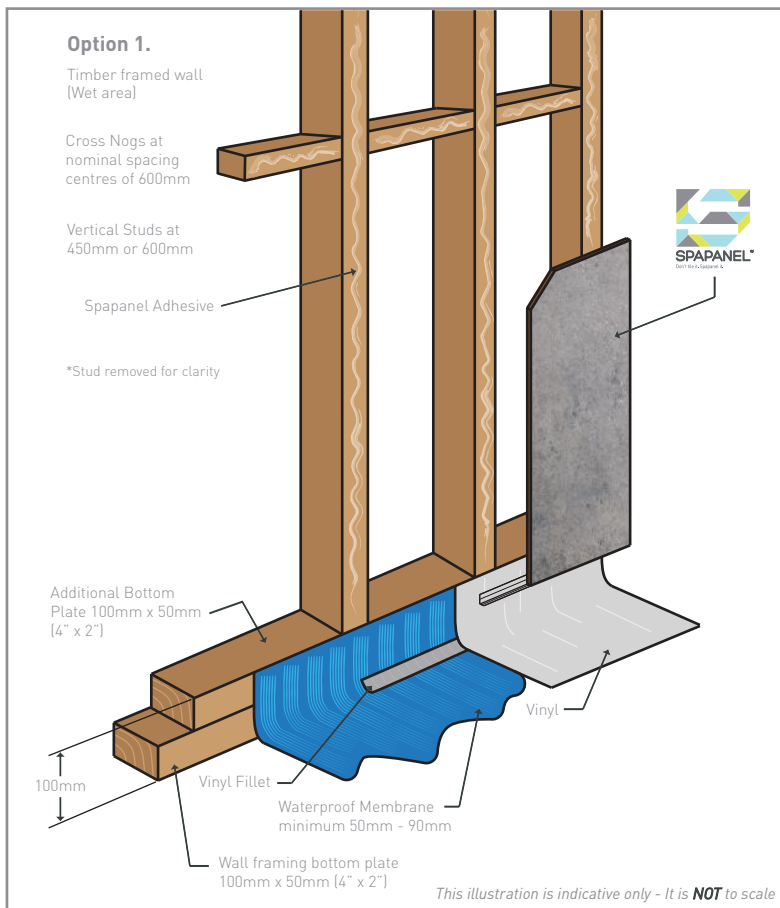

Finishing at the base of the panel

Option 2: Finishing onto tile skirting (tile on edge)

What to use - Use the Type X Profile, (See diagram Option 2 below)

- (1) Lay a generous bead of silicone sealant to the top of the tile skirting. Next apply another generous bead of sealant to the back upright of the Type X profile and bed the Type X profile on the previously applied sealant on the tiled skirting.
- (2) SS CS 4mm x 35mm Screws, fix the Type X profile into the wall, timber framework or timber battens.
- (3) Apply a continuous line of sealant onto the Type X back upstand and the panel support nib. Ensure the sealant exceeds the height of the support nib.
- (4) After installing a Spanpanel board smooth off and remove any excess sealant at the bottom of the panel where your Spanpanel board meets the Type X profile.
- (5) Apply extra sealant if required.

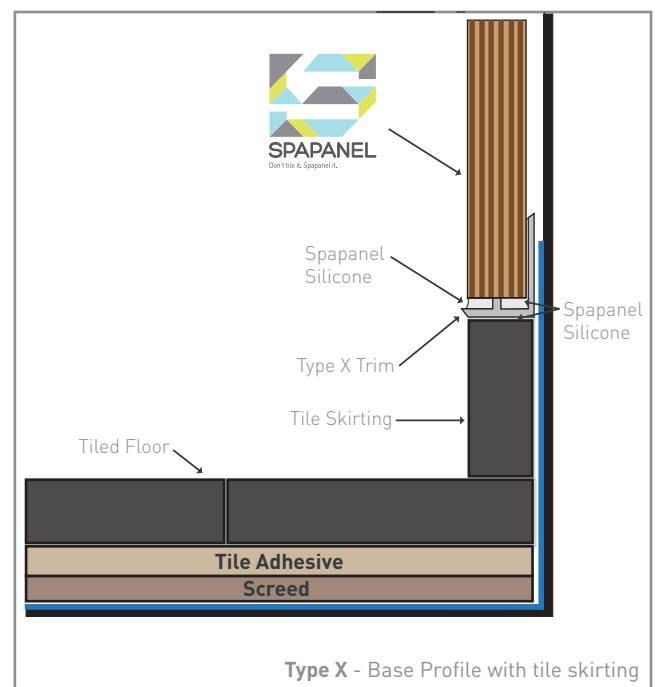
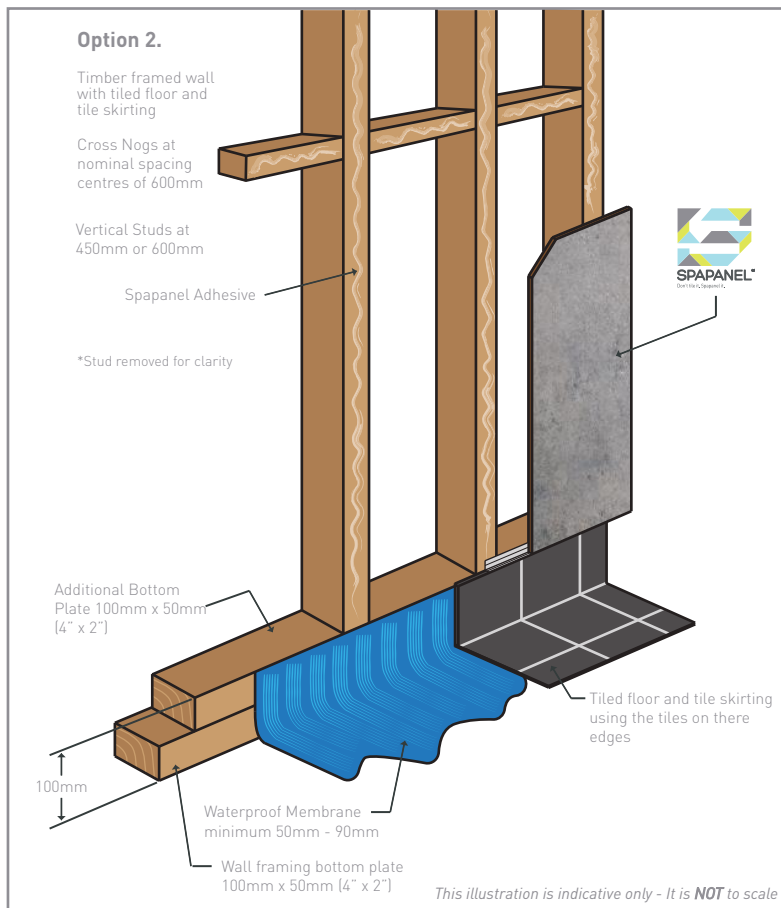

Finishing at the base of the panel

Option 3a: Finishing onto a pre-tiled floor using the Sureseal profile.

NOTE: In all high wet areas (shower zone) the Spanpanel Base Seal trim **OR** Sureseal profile **MUST** be used.

- (1) Cut to length the Sureseal profile, mitre-cut for corners and make notches for any supporting profiles.
- (2) Lay the Sureseal strips in position to check the mitre cuts and notches match. With the strips in position, lightly mark the floor tiles (at multiple points with a pencil) to define the outer edge of each strip.
- (3) Turn and hold the Sureseal strip upside down and apply a thick line of sealant along the full length of the trim. Spread sealant into the Sureseal strip with a sealant smoothing tool. Redistribute or add sealant if required. Ensure that the sealant is buffered flush with the ends of the strip.
- (4) With a finger under the sealant nozzle and a fingertip against the wall as a guide, lay a straight continuous and generous bead of sealant on the floor tiles just inside the pencil marks which indicate the outer edges of the strip.
- (5) Place the first Sureseal strip into position fusing the sealant in the strip with the sealant on the floor tiles. Check the strip is sitting level using a spirit level.
- (6) When using Sureseal the height of the panel should be taken from the top of the flexible nib of the base trim (A) to the ceiling. This will allow the necessary clearance to install your panel.

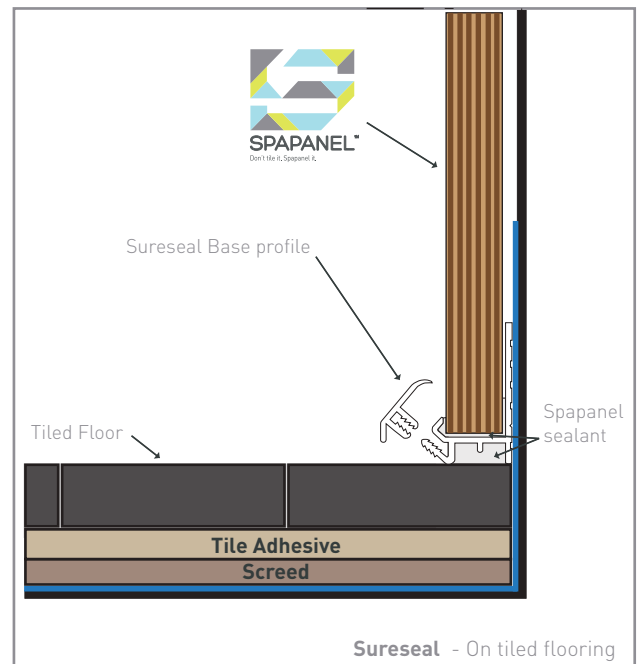
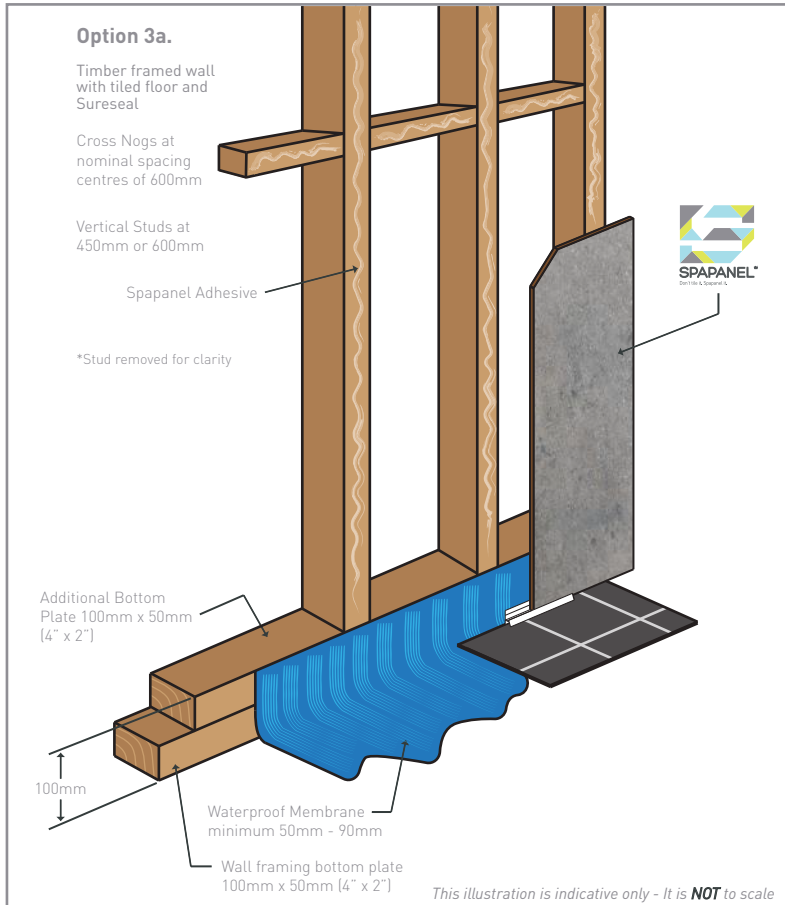
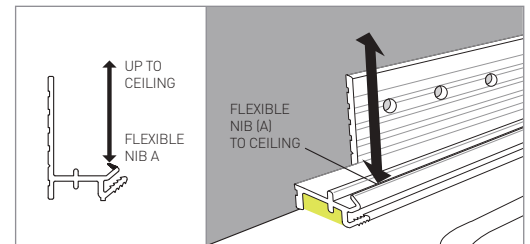

Finishing at the base of the panel

Option 3b: Finishing onto a shower base or bath tub using the Sureseal Profile.

NOTE: In all high wet areas (shower zone) the Spanpanel Base Seal trim **OR** Sureseal profile **MUST** be used.

- (1) Cut to length the Sureseal profile, mitre-cut for corners and make notches for any supporting profiles.
- (2) Lay the Sureseal strips in position to check the mitre cuts and notches match. With the strips in position, lightly mark the shower base or bath tub (at multiple points with a pencil) to define the outer edge of each strip.
- (3) Turn and hold the Sureseal strip upside down and apply a thick line of sealant along the full length of the trim. Spread sealant into the Sureseal strip with a sealant smoothing tool. Redistribute or add sealant if required. Ensure that the sealant is buffered flush with the ends of the strip.
- (4) With a finger under the sealant nozzle and a fingertip against the wall as a guide, lay a straight continuous and generous bead of sealant on the shower base or bath tub just inside the pencil marks which indicate the outer edges of the strip.
- (5) Place the first Sureseal strip into position fusing the sealant in the strip with the sealant on the shower base or bath ledge. Check the strip is sitting level using a spirit level.
- (6) When using Sureseal the height of the panel should be taken from the top of the flexible nib of the base trim (A) to the ceiling. This will allow the necessary clearance to install your panel.

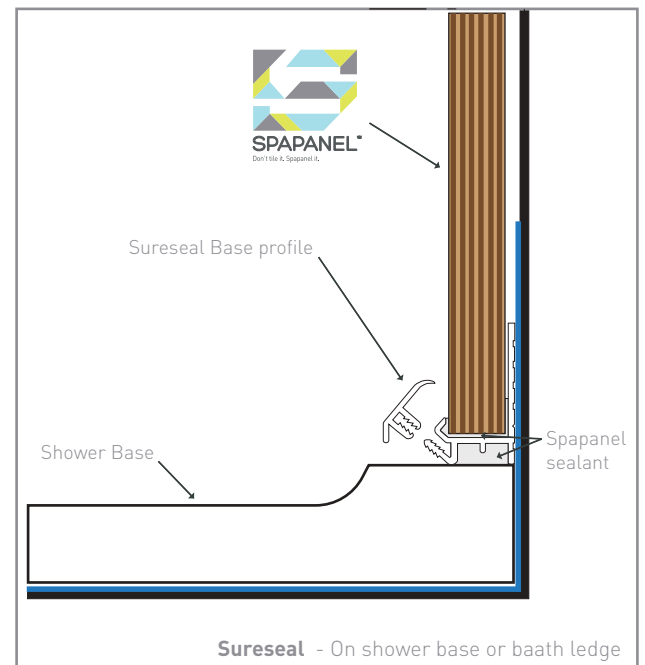
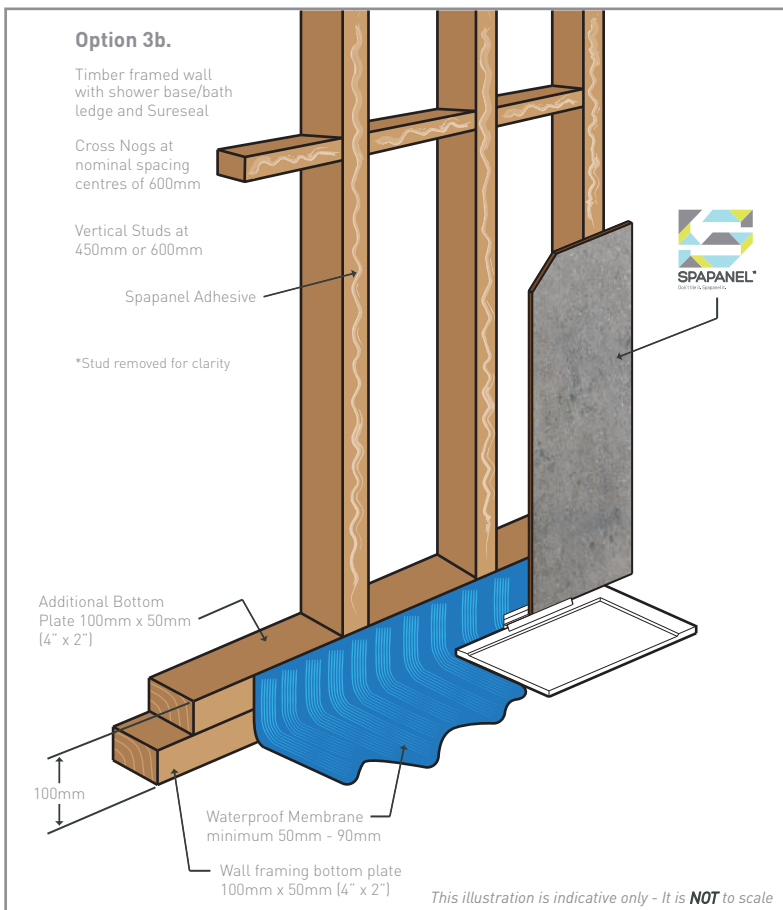
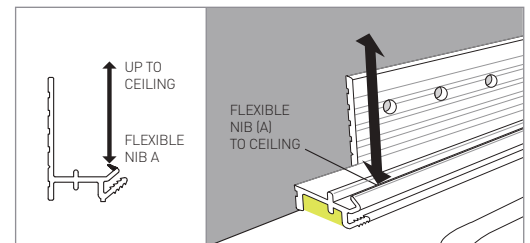

Finishing at the base of the panel

Option 3c: Finishing onto pre-tiled floors and silicone sealing outside high wet areas.

NOTE: In all high wet areas (shower zone) a Spapanel Base Seal trim, Sureseal or Type X Base profile **MUST** be used

- (1) Install Spapanel leaving a 3mm gap between the base of the panel and the floor tiles. The use of 3mm packers is recommended.
- (2) Generously apply recommended sealant at the base of the panel, ensuring that the sealant goes completely under and fills entirely the 3mm space.
- (3) Using a silicone smoothing tool, smooth off the sealant to your desired thickness.
- (4) Regularly check, maintain or re-apply sealant over time when necessary.

It is strongly advised that you only use Adhesives and sealants that have been approved or recommended by Spapanel.

NOTE: Using poor quality adhesives or sealants or one that has not been recommended may invalidate your warranty.

It is the owners responsibility to periodically check the performance of any sealant and must notify the installer **ASAP** if they feel that it needs attention or replacement. Failure to maintain the sealant may invalidate the product warranty and guarantee.

NOTE: Exposed bottom edge sealants may need to be replaced periodically and/or as necessary dependent upon shower usage.

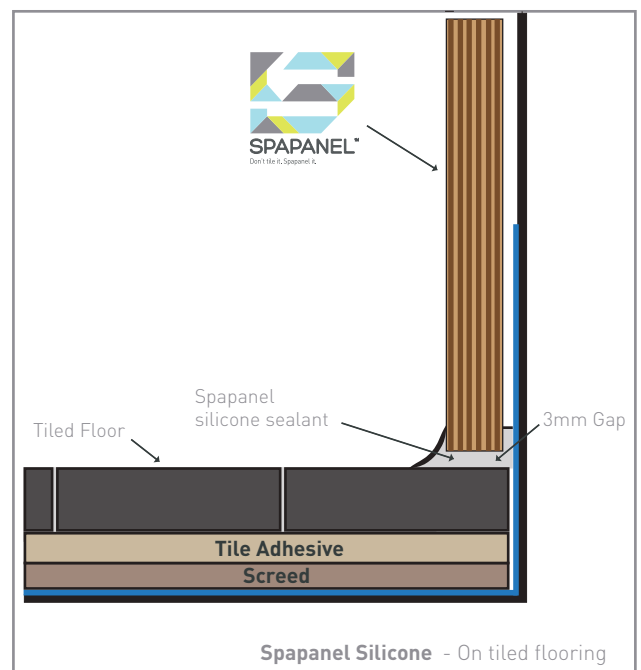
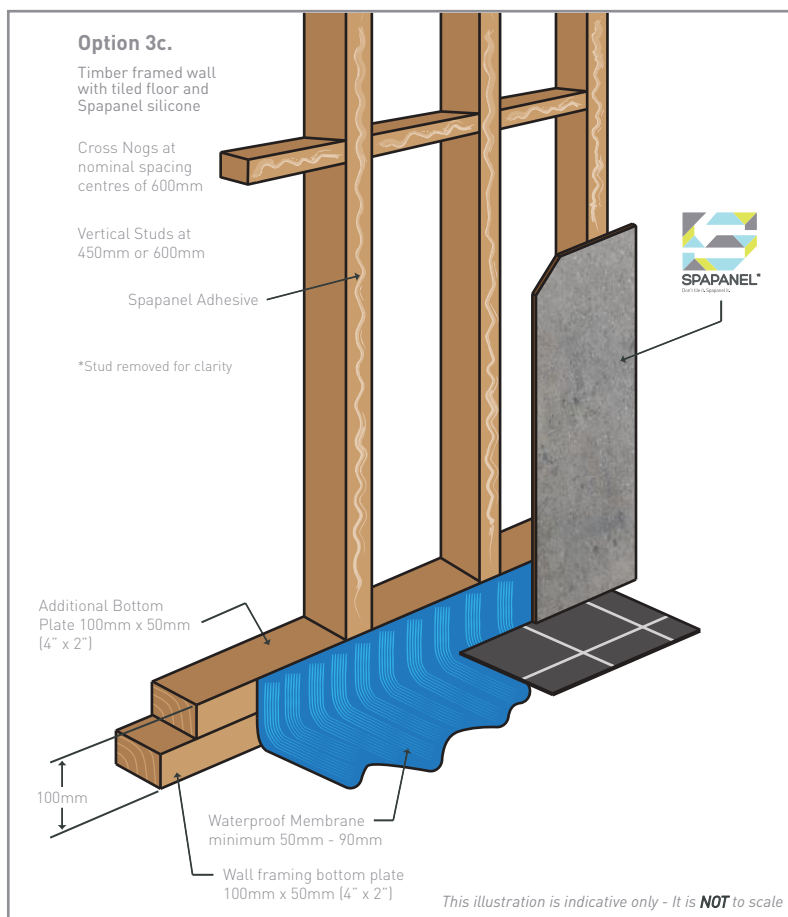

Finishing at the base of the panel

Fitting the Sureseal

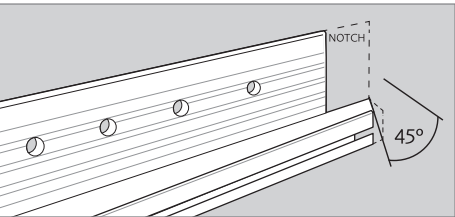

NOTE: Notches (cut outs) should be made for all variants of profile trims that are used in conjunction with the Sureseal strip.

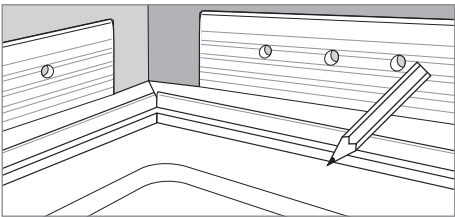

Lay the Sureseal strips in position to check the mitre cuts and notches match. With the strips in position, lightly mark the shower base, bath ledge or floor tiles (at multiple points with a pencil) to define the outer edge of each strip.

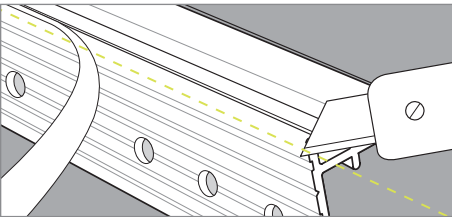

If the front edge of the Sureseal strips are not resting flat on the shower base, bath ledge or floor tiles, score and tear off the removable back leg as shown.

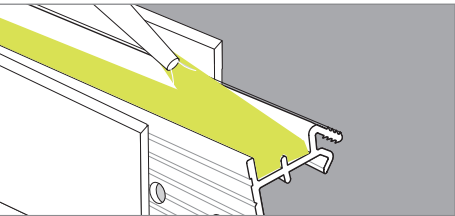

Insert the Sureseal strip upside down and apply a thick line of sealant along the full length of the trim.

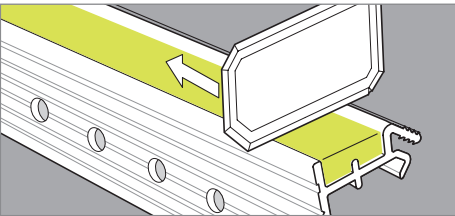

Spread sealant into the Sureseal strip with a sealant smoothing tool. Redistribute or add sealant if required. Ensure the sealant is buttered flush with ends of the strip.

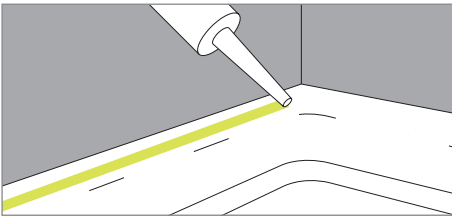

With a finger under the sealant nozzle and a fingertip against the wall as a guide, lay a straight continuous and generous bead of sealant on the shower base, bath ledge or floor tiles just inside the pencil marks which indicate the outer edges of the strip.

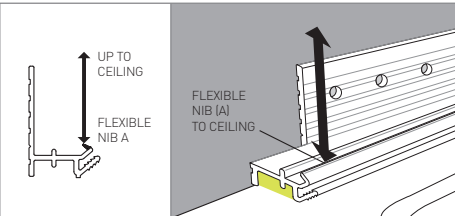

When using Sureseal the height of the panel should be taken from the top of the flexible nib of the base trim (A) to the ceiling. This will allow the necessary clearance to install your panel.

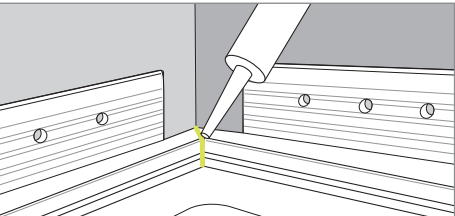

Place the first Sureseal strip into position fusing the sealant in the strip with the sealant on the shower base, bath ledge or floor tiles. Check the strip is sitting level using a spirit level.

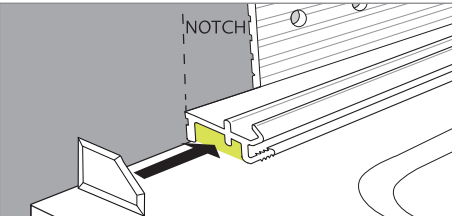

Insert the Sureseal end caps into the exposed end of the Sureseal strip. Ensure that the end cap tabs are seated into the Sealant.

Finishing at the base of the panel

Option 4: Finishing Spapanel behind tiled flooring

What to use - Recommended Silicone sealant

NOTE: In all high wet areas (shower zone) the PVC End Cap **MUST** be used.

- (1) Install Spapanel leaving a gap of 20mm-25mm between the bottom of the panel and the floor.
- (2) When using the PVC, u-shaped End Cap, fill the channel with our recommended silicone sealant and then place onto the bottom of the installed Spapanel. Wipe away any excess silicone with a damp cloth or tissue.
- (3) Screed and then tile the floor (following the current BCA guidelines) to the base of the Spapanel boards.
- (4) Fill and seal the gap between the tiles and Spapanel with our recommended Spapanel Silicone. Regularly check and maintain or replace the sealant over time if required.

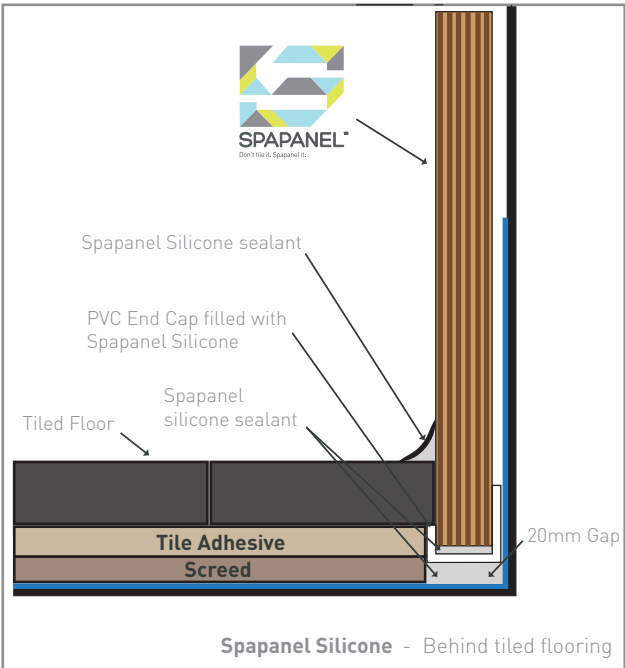
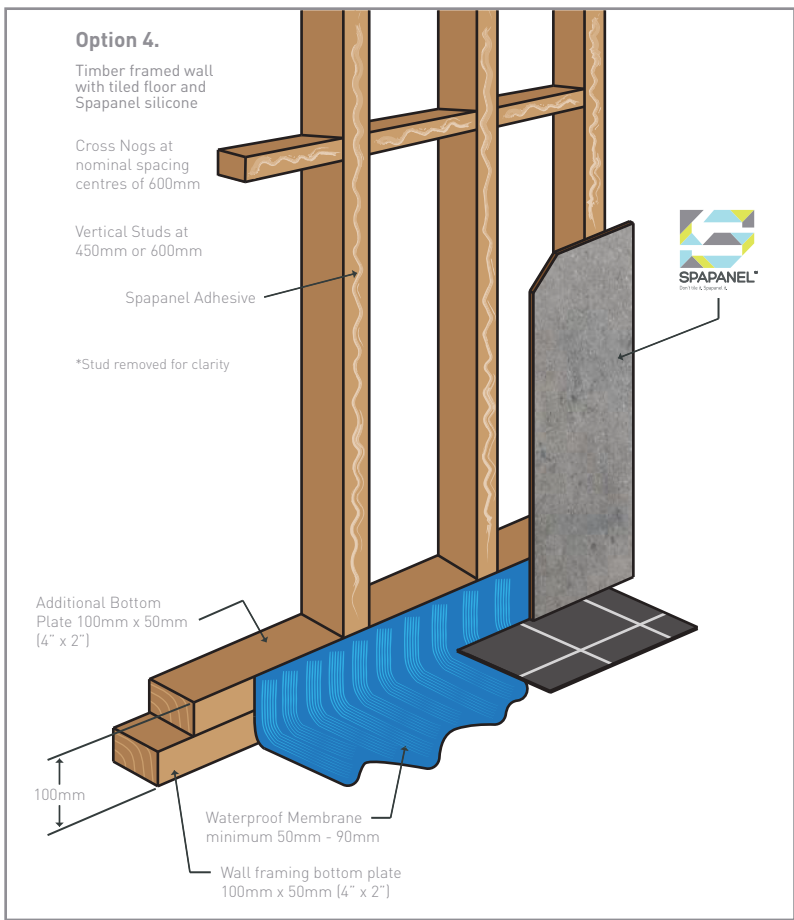

Finishing at the base of the panel

Option 5: Finishing behind tiled skirting (tile on edge)

What to use - Recommended Silicone sealant

NOTE: In all high wet areas (shower zone) the PVC End Cap **MUST** be used.

- (1) Install Spapanel leaving a gap of 20mm-25mm between the bottom of the panel and the floor.
- (2) When using the PVC, u-shaped End Cap fill the channel with our recommended silicone sealant and then place onto the bottom of the installed Spapanel. Wipe away any excess silicone with a damp cloth or tissue.
- (3) Screed and tile the floor (following BCA guidelines) finishing the tile to the base of the Spapanel board.
- (4) Fill and seal the gap between the tiles and Spapanel with our recommended Spapanel Silicone.

NOTE: Regularly check and maintain or replace the sealant over time if required.

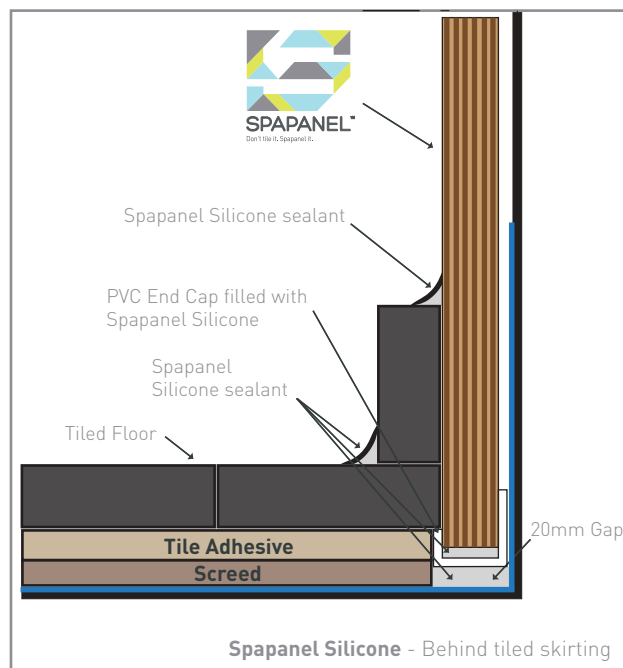
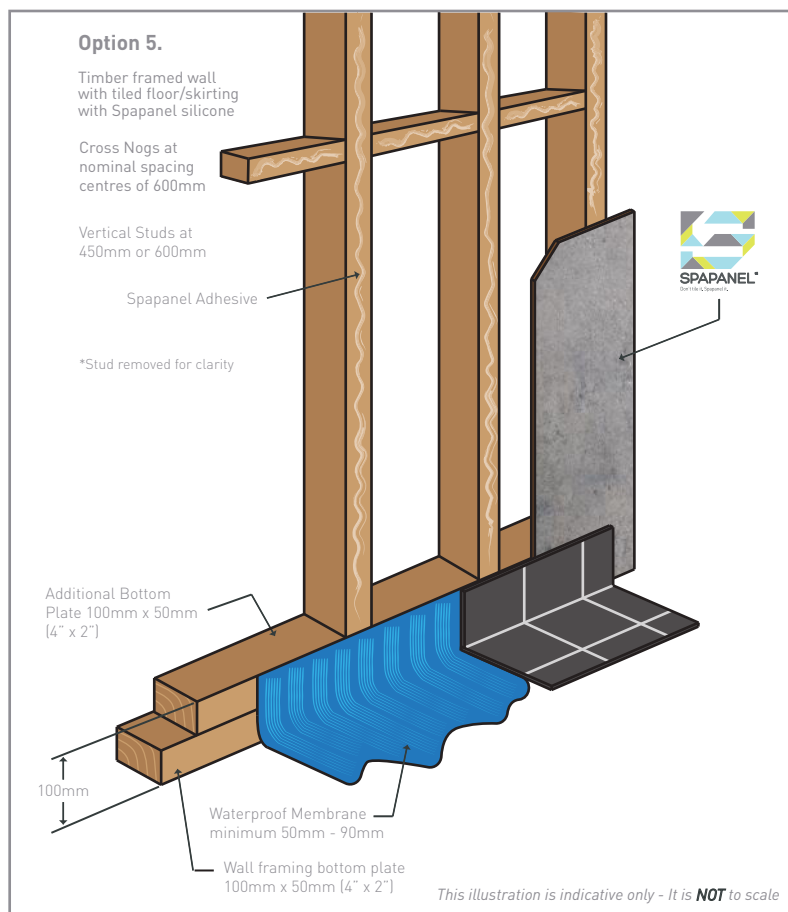

Fixing Hydrolock® tongue & groove panels

Prior to installation it is strongly recommended that the Hydrolock® panels are conditioned in the room (or similar environment) where they will be installed for 72 hours. This is particularly important in cold conditions.

Hydrolock® tongue and groove panels should be dry jointed, prior to final installation to ensure a sufficiently flush and tight joint is achieved between all panels. Hydrolock® panels **MUST** be silicone sealed at all vertical joints, as well as all extrusions, joints and at the bottom of the panels.



Hydrolock® panels can be screw-fixed using SS CS 3.5mm x 25mm Screws or bonded to the wall, tile or framework using Soudal FixAll High-Tack or Soudaseal 240FC.

The bottom screw should be a maximum of 150mm from the bottom edge of the panel.

When manufacturing Hydrolock® joints, 20mm is lost from the original panel width – please allow for this when calculating panel requirements and before creating framework.

E.g. 2400 x 1200mm = 2400 x 1180mm finished face size

Hydrolock® panels are supplied as standard with a tongued long edge and a grooved long edge. When fitting panels into an extrusion, the protruding tongue or grooved edge should be cut off.

Bond the first panel to the wall or frame, with the grooved edge first. If screw fixing panels use SS CS 3.5mm x 25mm Screws to the wall/frame, pilot bore the recess in the groove where screws are to be located.

(Failure to pilot bore may result in the panels splitting).

Pack between back of panel and wall as necessary to avoid distortion to the Hydrolock® joint when screw fixing. Fix through the back flange of the grooved edge with countersunk screws - the screw head should fit into the recess on the back of the tongue.

Ensure that screws are turned until they are just flush, to prevent any obstruction to the tongue of the next panel to be fitted.

Apply masking tape to the two meeting edges of the decorative face to protect the laminate face. Apply a narrow bead (2-3mm) of silicone sealant to the front shoulder of the tongue.

NOTE: using too much silicone sealant will affect the tightness of the Hydrolock® joint. Using too little may affect watertightness.

Starting at approximately 45°, angle the tongue of the next panel into the groove of the fixed panel. Ensure the tongue is fully inserted into the groove before snapping it back to the wall; otherwise it may damage the joint.

Hidden internal corner installation

For a more natural and neutral corner finish

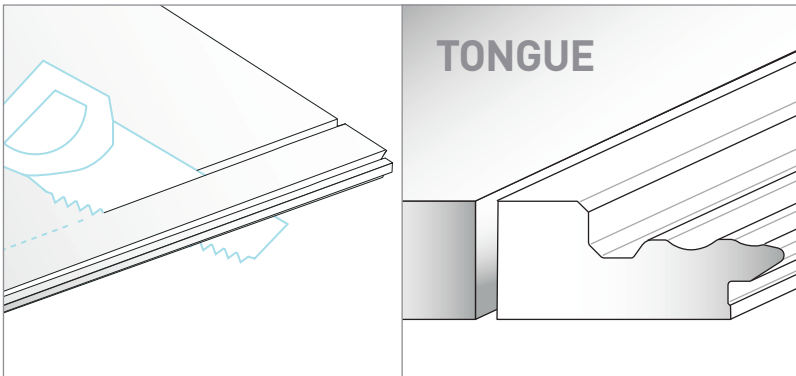

Step 1.

The Hydrolock® tongue or groove profile edge must be cut off to leave a square cut panel edge which will sit flush inside the extrusion.

NOTE: Repeat this procedure for each corner profile

Step 2.



Apply a sealant bead to the cut edge of the Spanpanel board and then screw-fix the hidden internal corner profile to the back face of the panel, using an 8mm screw. Use the pre-drilled and countersunk holes.

Step 3.



Offer up and place the panel with the pre-fitted hidden internal corner profile into the corner. Once straight and in place, screw fix the corner profile using the pre drilled and countersunk holes. Apply sealant to the next Spanpanel board before inserting into the corner profile.

Step 4.

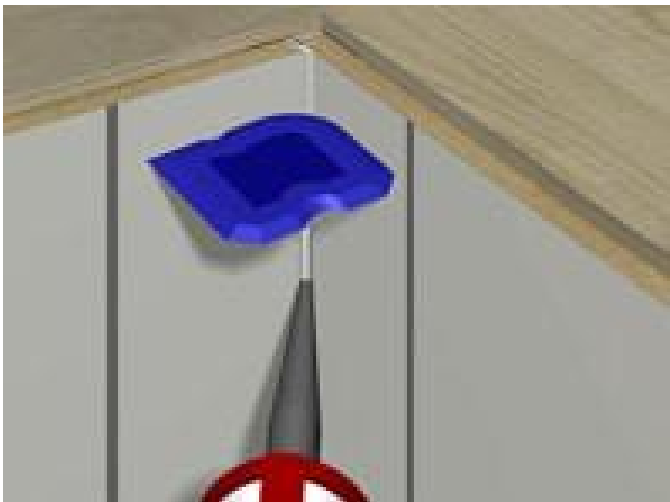

Apply sealant to the front face, and smooth off using a silicone smoothing tool.

Step 5.

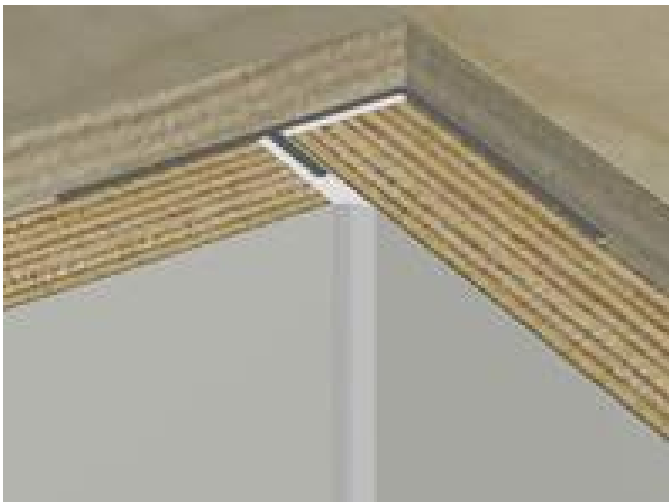

The finished appearance gives a more natural & neutral finish.

Installation - onto framework, using the standard internal corner with Hydrolock® tongue & groove panels

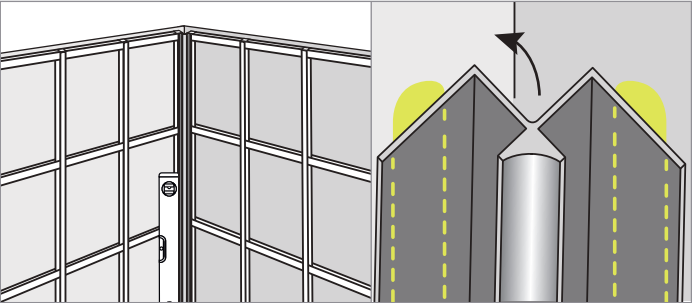

1. Apply a bead of panel adhesive to the full length of the reverse of the internal corner trim.
 Fix the Spanpanel internal corner trim in position ensuring that it is plumb using a spirit level

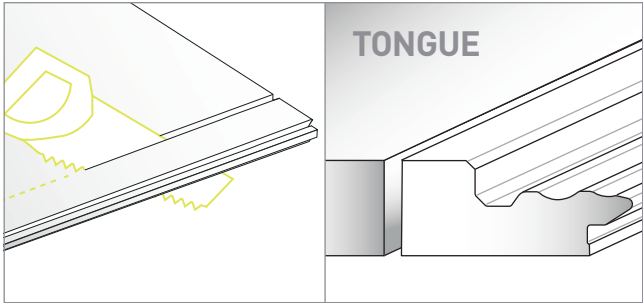

2. Cut the tongue profile off of your first panel to leave a square cut panel edge.
NOTE: Repeat this procedure at each starting corner

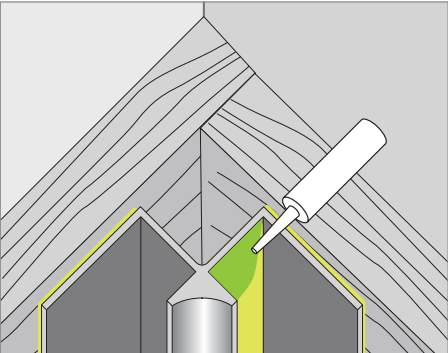

3. Apply sealant into the right hand channel recess of the internal corner trim in sufficient quantities to ensure the sealant fully envelopes the edges of the panel when installed

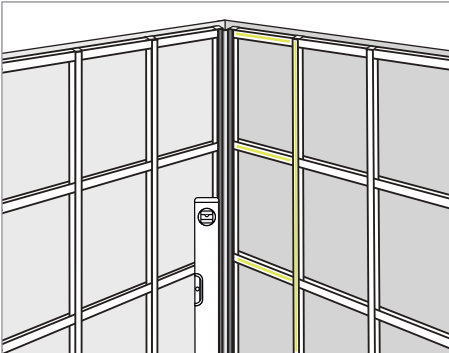

4. Apply adhesive in a snake like pattern to the timber framework.
NOTE: Apply even pressure across the panel face to ensure sound contact of the adhesive to the reverse of the panels. Repeat for each of the panels installed

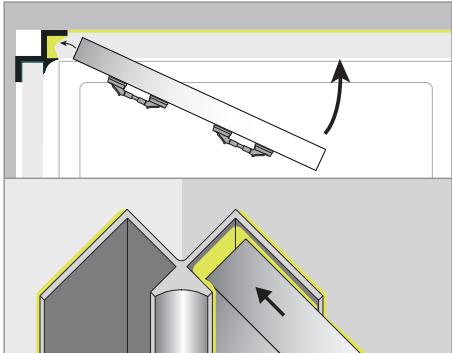

5. **FIRST PANEL INSTALLATION**
 Wipe all edges with a surface cleaning tissue. Slide the square cut panel into the previously installed corner trim ensuring the panel is firmly pushed into the trim recess and that the sealant fully envelopes the panel edge when installed.

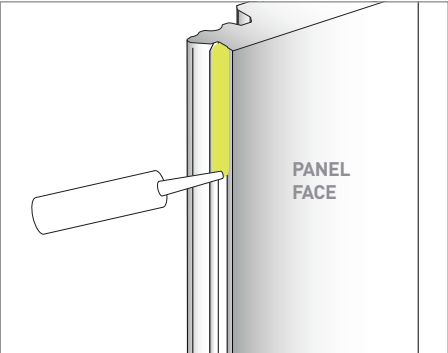

6. **SECOND PANEL INSTALLATION**
 Repeat the same adhesive application for the next section of battens (Step 4.) Using an uncut sealant nozzle, apply a small continual full length bead of sealant to the shoulder of the tongue profile of the next panel.

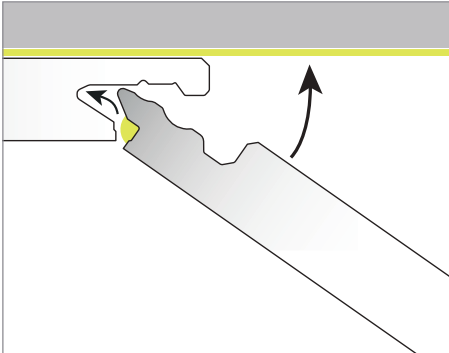

7. Angle the tongue of the panel into the groove of the previous installed panel, evenly squeezing out the sealant and close the gap.

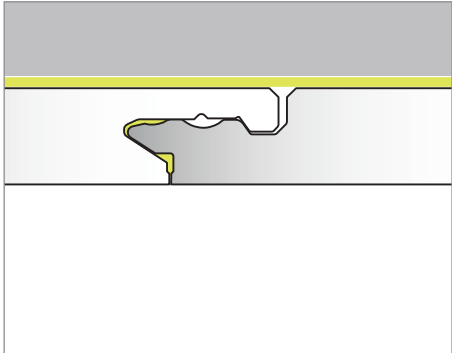

8. Immediately after assembling each joint clean off any sealant overspill from the joint on the panel face.
NOTE: A small visible dark line at the joint is not deemed as a product defect may it be present depending of decor and texture used.

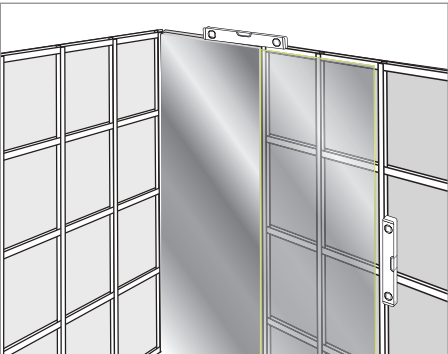

9. Repeat steps 6-7 for the following panels. Check each panel once installed to ensure the panel edges are plumb and level using a spirit level.
 Repeat for each of the panels installed.

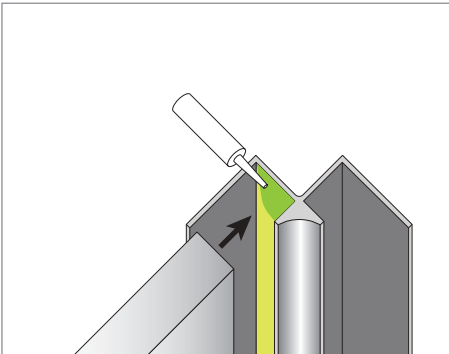

10. Measure and cut the final panel to width removing the groove side as necessary (same as Step 2.) Apply sealant into the left hand recess of an internal coner trim in sufficient quantity to ensure the sealant will fully envelope the edge of the panel. Firmly locate the trim onto the square cut panel edge.

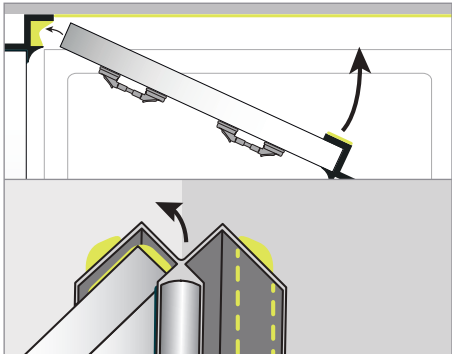

10. **REPEAT STEPS 4, 6 & 7**
 Locate the tongue profile of the panel into the groove of the previous installed panel and firmly push the panel and corner trim onto the adhesive beads and into position.

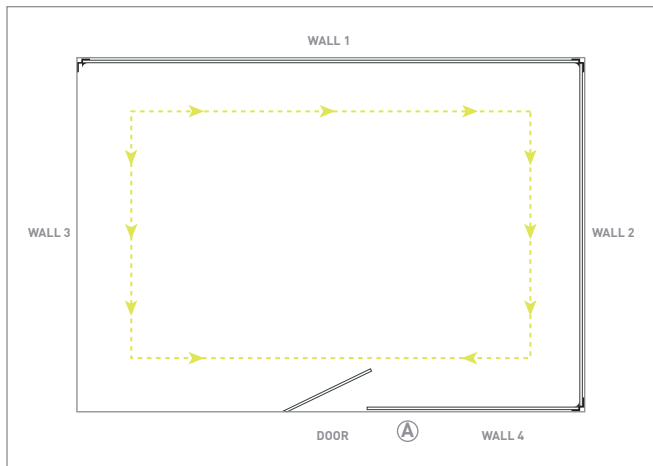

13. Repeat the procedures used for wall 1 to complete the installation of panels to walls 2 and the first section of wall 4 to the door waypoint (A)

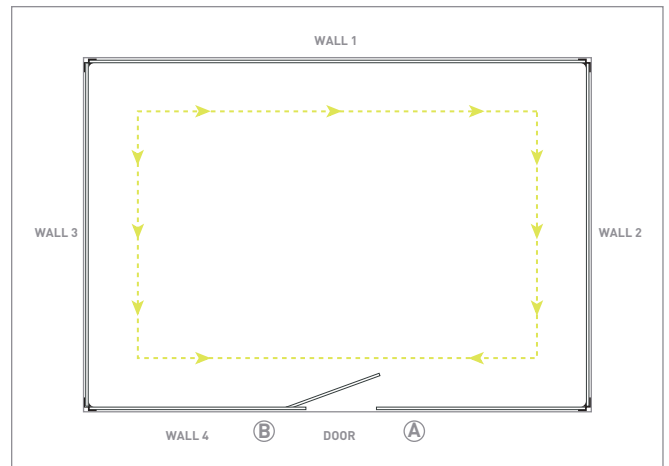

14. Repeat the procedures used for the wall 1&2 complete walls 3 and the second section of wall 4 to the doorway point (B) leaving sufficient space for the final panel above the door.

NOTE: Prior to installing your final panel cut off the projecting element of the groove profile level with the face of the panel leaving the groove intact in preparation for the final sealant application (as shown here)

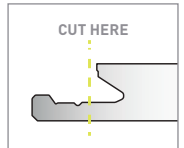

Installation of final or last panel for full room installation

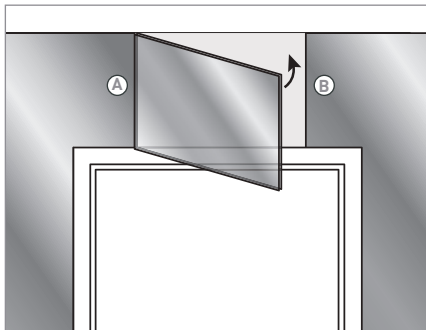

15. Measure and cut the height of the final panel above the door.

16. Measure and cut the width of the panel removing the right hand groove side of it. Ensure a clean straight cut is achieved.

Once cut, dry fit the panel to ensure accurate fitting. Remove the panel in preparation for panel fixing with suction cups.

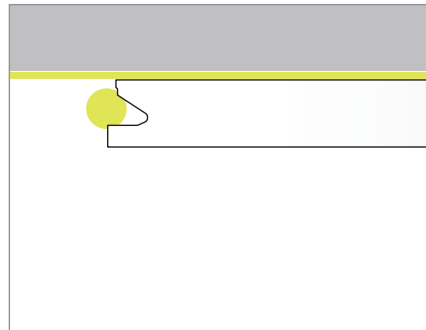

17. Apply adhesive in a snake like pattern to the appropriate battens.

Apply sealant to the left hand tongue of the panel as per Step 6.

Apply a bead of sealant into the groove of the previously installed right hand panel ensuring the sealant exceeds the edge of the panel as shown above.

Locate the tongue into the groove of the left hand panel (A) and rotate the final panel into position ensuring the panels are flush across the right hand joint (B)

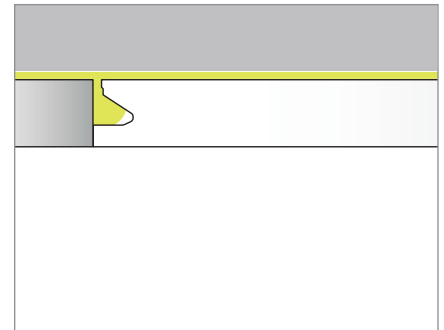

18. Immediately after assembling each joint, clean off any sealant overspill from the joint and face of the panel.

19. Seal the top and bottom of the installation as advised in section 3.

20. COMPLETION

Allow the adhesive and sealant to fully cure for 12-24 hours. After installation of your chosen shower cubicle clean your Spanpanel boards using a recommended cleaner.

External corners

Where Spanpanel boards are being used to cover 90° wall returns or pipe box sections, use the Spanpanel external corner and/or internal corner trims.

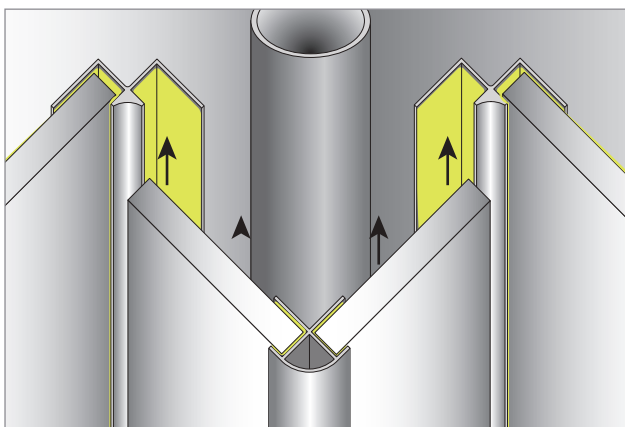

NOTE: It may be necessary that the external trim and cut panels are fabricated as one unit and fixed into the previously installed internal corner trims to complete the install.

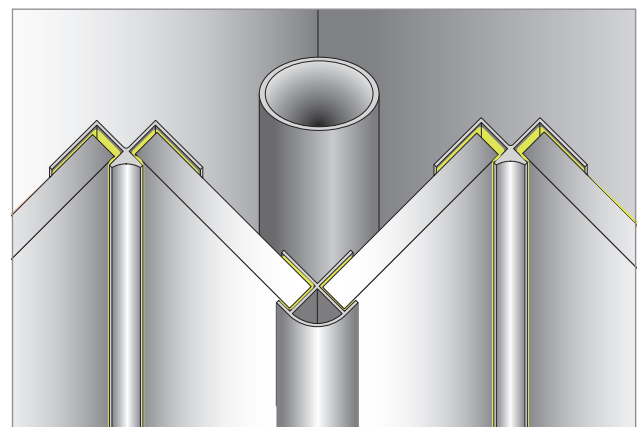

Ensure all trims are fixed with adhesive and the trim recess' are filled with sealant prior to installing the panel sections.

Window reveals

Use the Spanpanel external corner trim for each external corner point around your window reveals.

NOTE: A mitre box is required for this element of installation.

Ensure all trims are fixed with adhesive and all trim recess is filled with sealant prior to installing the panel sections.

Measure and cut the final panel sections ready for installation

Dry fit each section to ensure correct angles, sizes and a neat fit

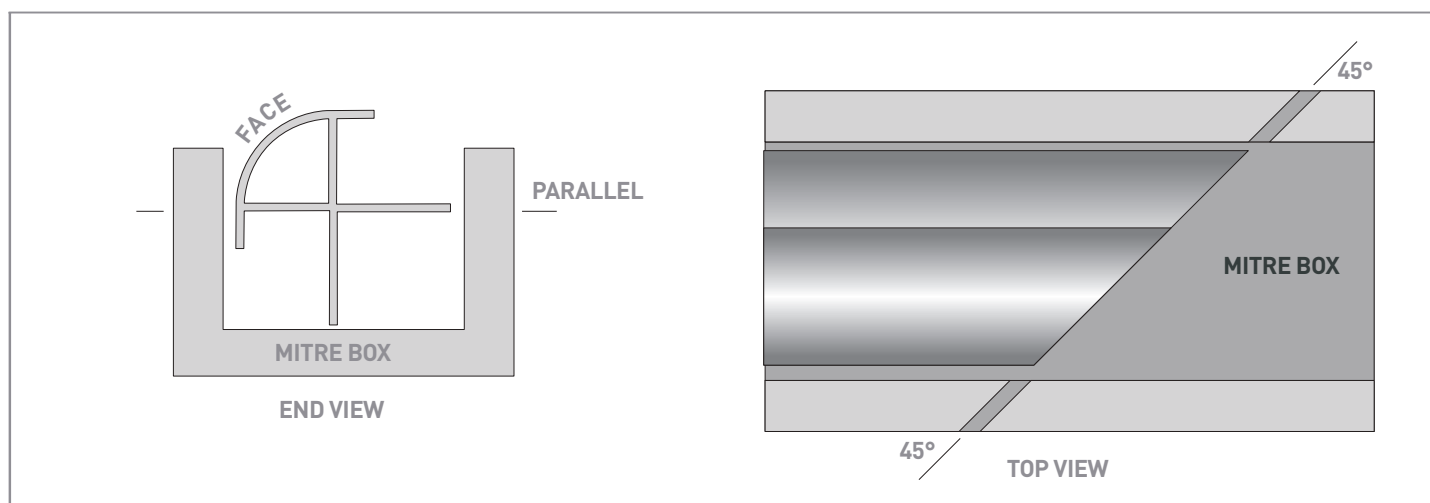
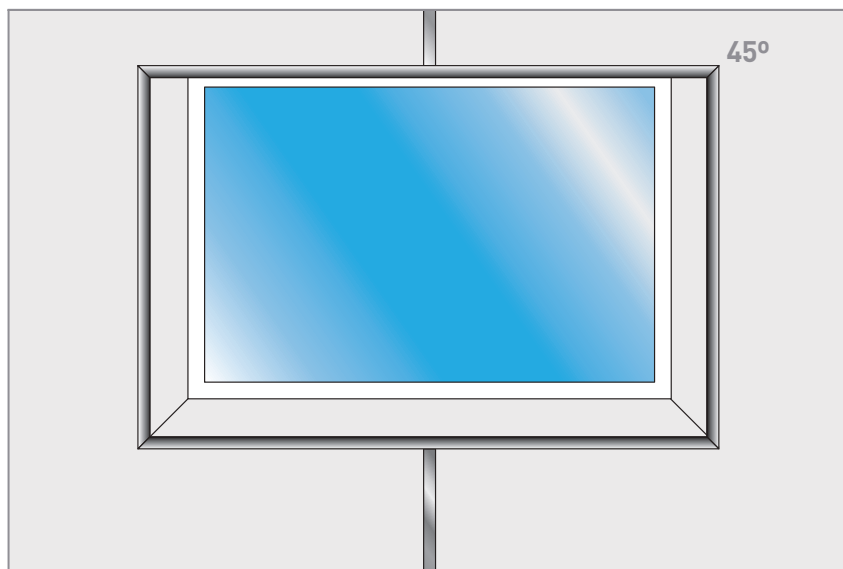

Measure and compound mitre cut each section of external corner trim as required. Ensure the trim is placed in the mitre box correctly so that the correct compound angle is achieved.

Once the trims have been correctly mitre cut to length and checked for accurate fitting, fix the trims in place using adhesive in the same manner previously detailed.

Next, apply adhesive to the window reveal wall sections in the same manner as detailed in step 4 of section 3.

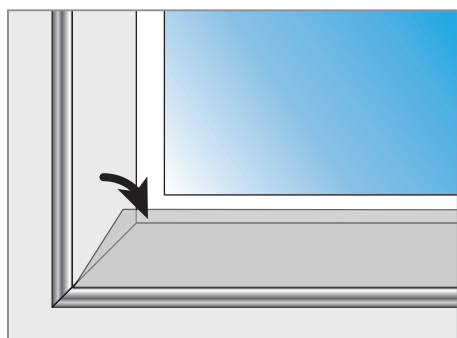

Install the two horizontal (top and bottom) sections first by inserting the panel into the trim recess at an angle ensuring that it is then fully pushed onto the adhesive

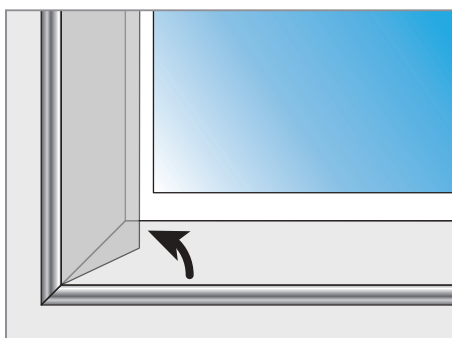

Proceed on installing the two vertical (sides) sections using the same method

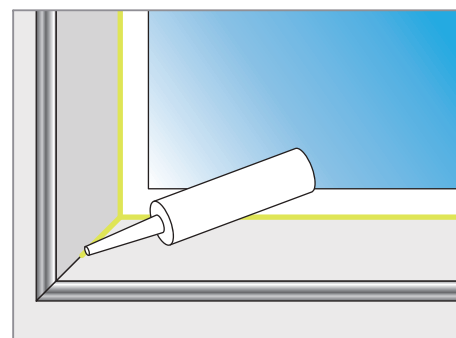

Complete the installation by applying sealant across the top and bottom corner (joints and rear) edges that meet the window frame

Pipes / Holes / Cut outs - Sealing

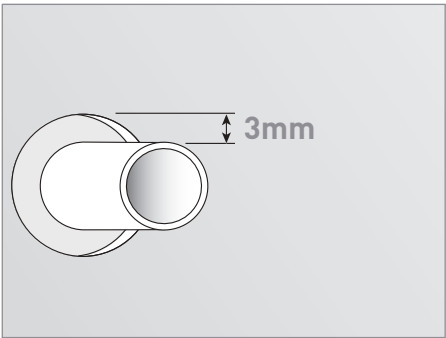

When needing to cut out, or drill holes, into your Spanpanel to accommodate pipes or shower units, ensure a clearance space of 3mm width is left between the fixed object being cut around and the panel edge.

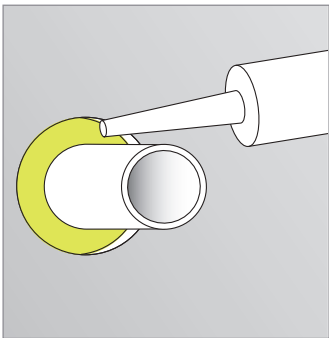

The 3mm clearance space must then be fully filled with sealant once the panels are installed and before any fittings or shower units are fitted.

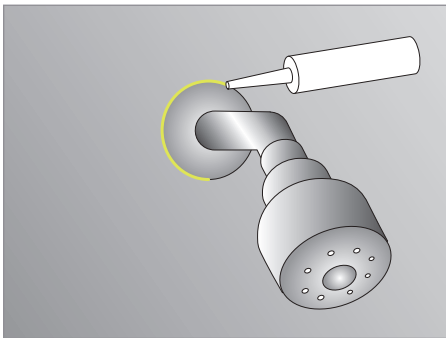

Following the fitting of any shower units or pipe collars etc. always seal the shower unit casting or pipe collars again to ensure a further watertight seal exists externally around the units and collars.

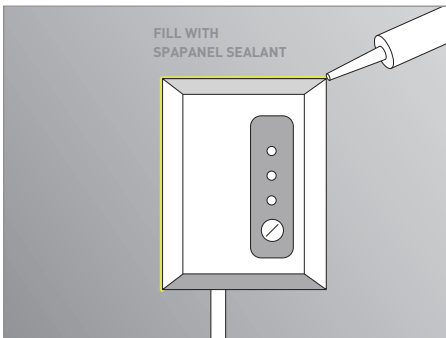
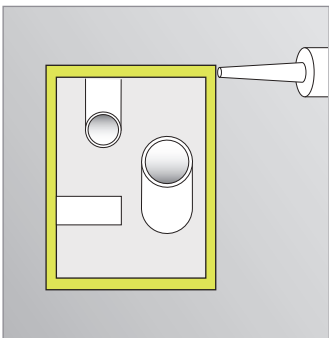
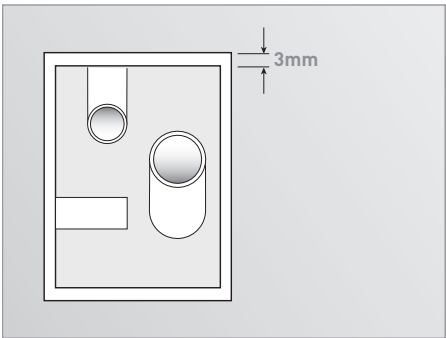

NOTE: Failure to adequately seal any cut edge sections of the panel may result in the ingress of water and will invalidate your product guarantee

Installation of the W.A.S Niche System

The W.A.S niche system must be purchased through Wet Area Solutions and installed in accordance to W.A.S guidelines.

The W.A.S niche is constructed from stainless steel. Primed and powder coated in colours, satin, chrome or black.

Sizes Available: 300mm x 300mm x 1mm / 600mm x 300mm x 1mm

For more information or to purchase the W.A.S niche system please visit www.wasaaustralia.com





SPAPANEL™

Don't tile it. Spapanel it.

Contact Us.

info@spapanel.com.au

www.spapanel.com.au



www.facebook.com/spapanel



www.twitter.com/spapanel_it



www.pinterest.com/spapanel



www.instagram.com/spapanel



www.houzz.com.au/pro/spapanel/spapanel

**MADE IN
BRITAIN**

